

RECT. TUBE

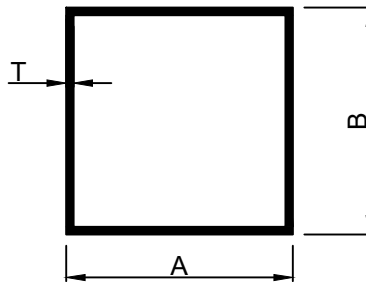

SEC.No.	A	B	T	Wt.(kg/Mtr.)	Wt.(kg/12')
11401	36.00	24.00	0.69	0.204	0.750-0.850

SQ. TUBE



SEC.No.	A	B	T	Wt.(kg/Mtr.)	Wt.(kg/12')
11351	23.00	23.00	0.55	0.125	0.450-0.600

SHREENATHJI EXTRUSION

SEC. NO:-30177

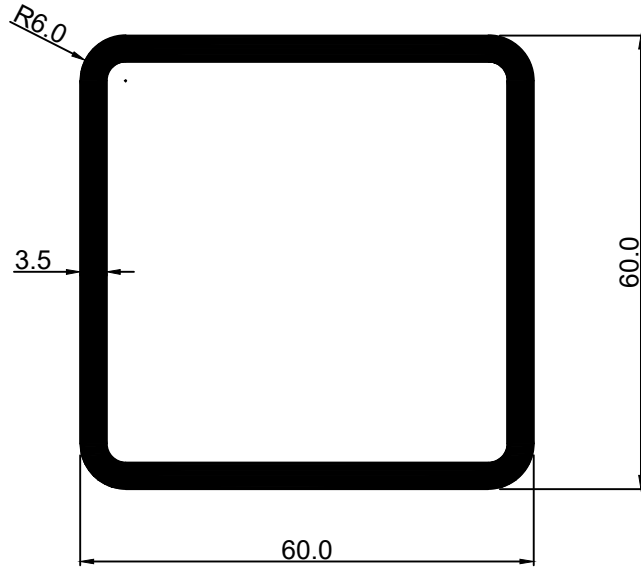

WEIGHT:- 7.565 kg/12'

SEC. NO:-30178

AH-329

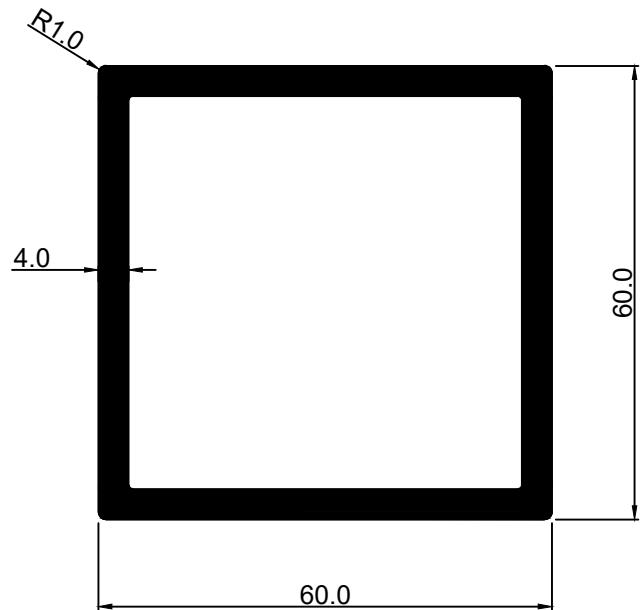

WEIGHT:- 8.850 kg/12'

SHREENATHJI EXTRUSION

SEC. NO:-30191

AH-284

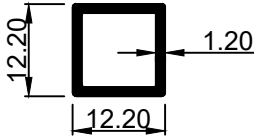

WEIGHT:- 0.521 kg/12'

SEC. NO:-30329

8024

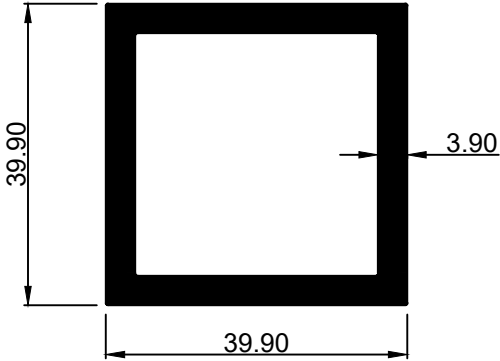

WEIGHT:- 5.560 kg/12'

SEC. NO:-30195

AH-343

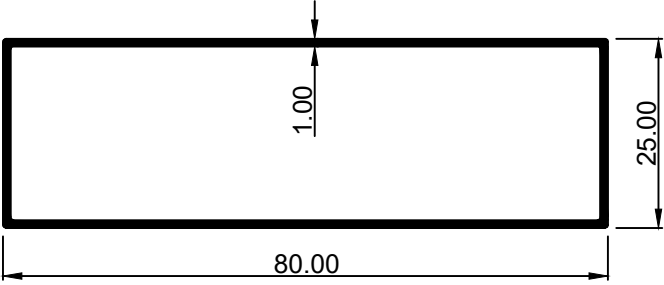

WEIGHT:- 2.035 kg/12'

SEC. NO:-30596

SE-168

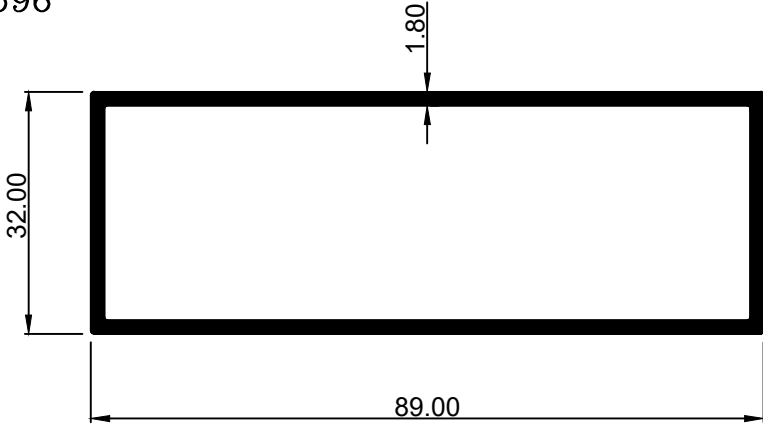

WEIGHT:- 4.176 kg/12'

SHREENATHJI EXTRUSION

SEC. NO:-30578

SE-150

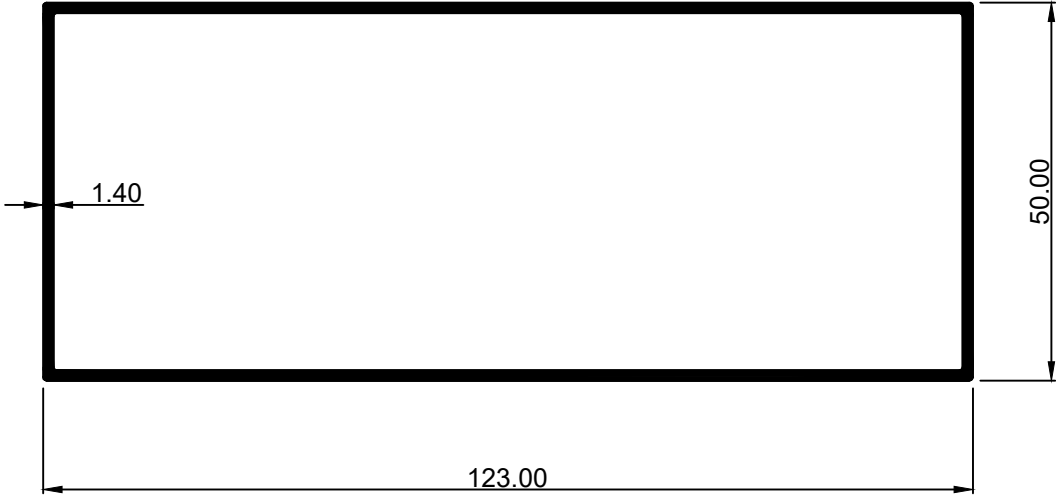

WEIGHT:- 4.708 kg/12'

SECTION No.:- SE-719

SECTION No.:- SE-720

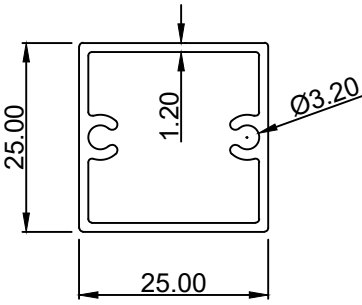

1.360 Kg/12'

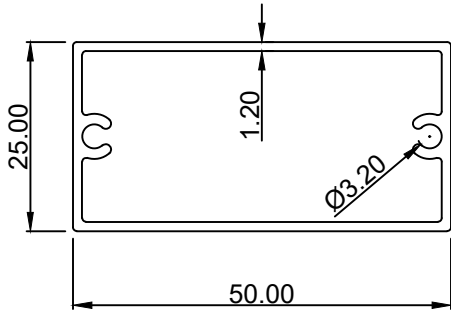

1.952 Kg/12'

SHREENATHJI EXTRUSION

SECTION No.: -SE-779

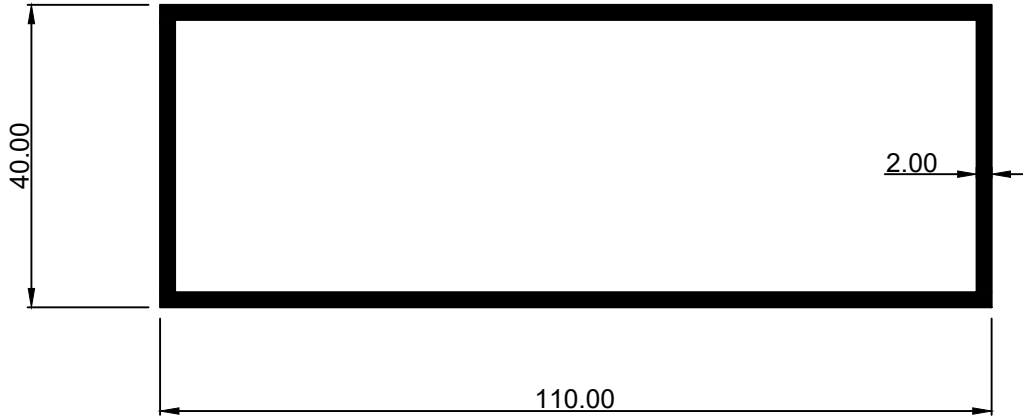

5.7710 Kg/12'

SECTION No.: -SE-807

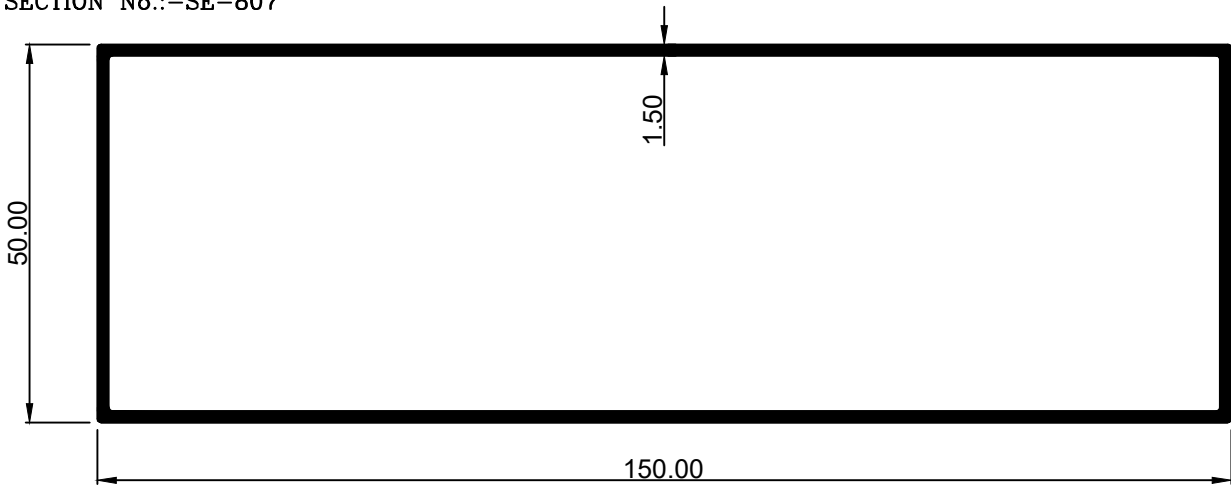

5.8402 Kg/12'

SECTION No.: -SE-757

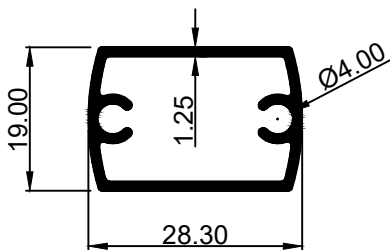

1.297 Kg/12'

SECTION No.: -SE-413

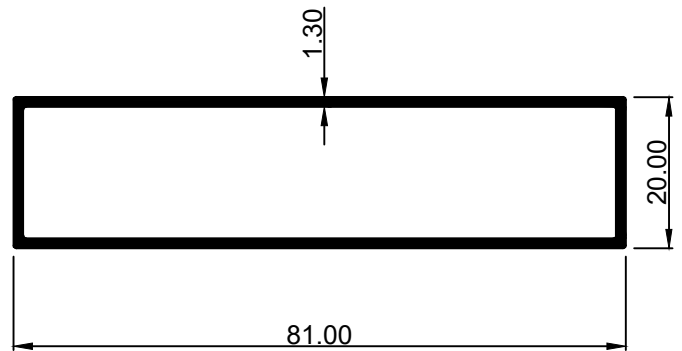

2.528 KG/12'

SHREENATHJI EXTRUSION

SECTION No.:- SE-414

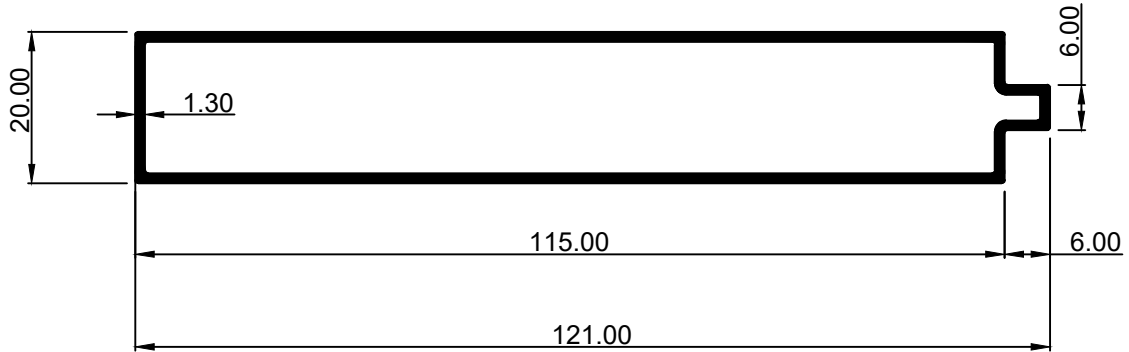

3.547 KG/12'

SECTION No.:- SE-530

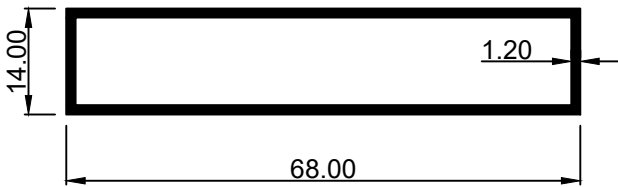

1.88785 Kg/12'

SECTION No.:- SE-526

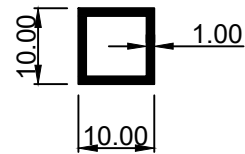

0.355752 Kg/12'

SECTION No.:-SE-667

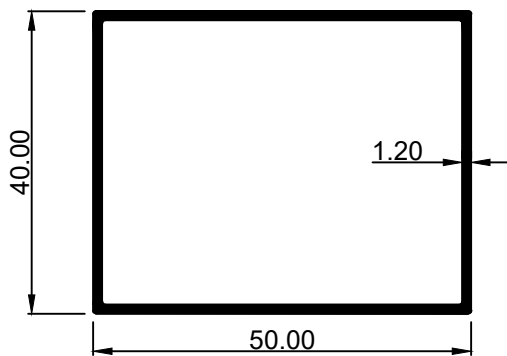

2.077 Kg/12'

SECTION No.:-SE-681

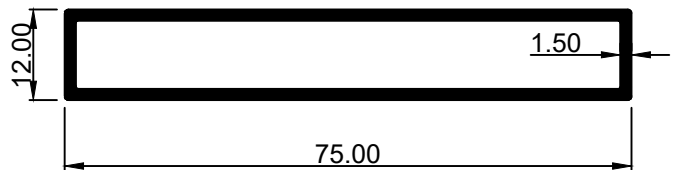

2.487 Kg/12'

SHREENATHJI EXTRUSION

SECTION No.:—SE—682

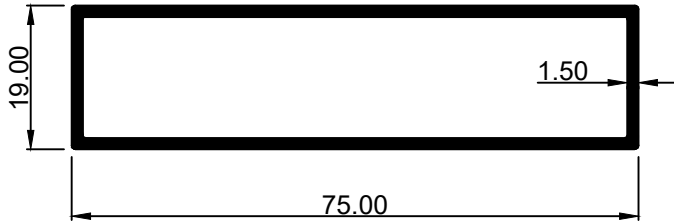

2.700 Kg/12'

SECTION No.:—SE—685

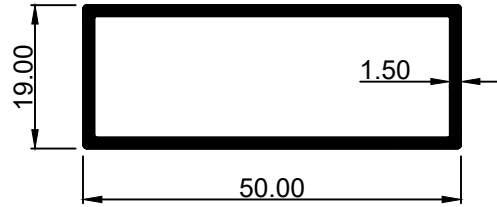

1.954 Kg/12'

SECTION No.:—SE—683

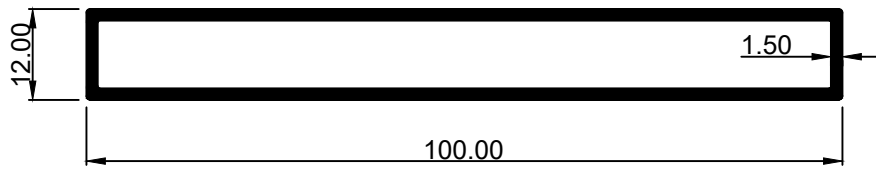

3.234 Kg/12'

SECTION No.:—SE—684

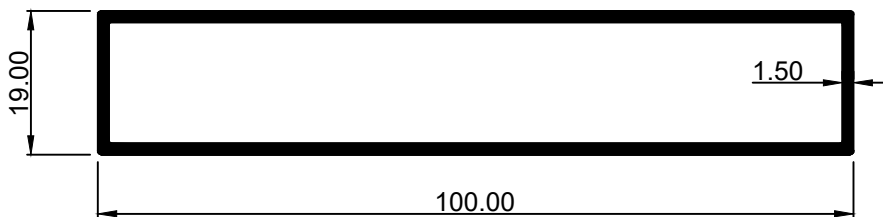

3.442 Kg/12'

SHREENATHJI EXTRUSION

SECTION No.:--SE-692

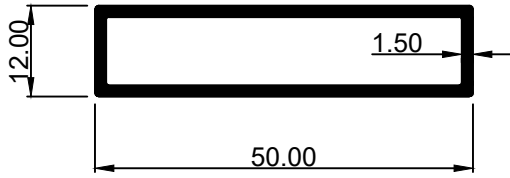

1.747 Kg/12'

SECTION No.:--SE-693

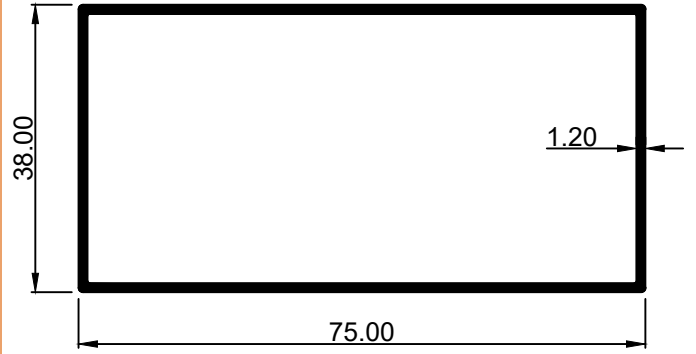

2.620 Kg/12'

SECTION No.:--SE-900

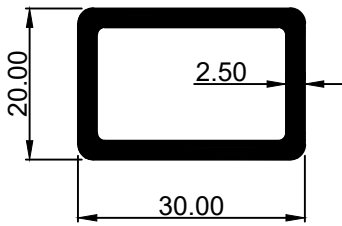

2.1980 KG/12'

SECTION No.:-- SE-1173

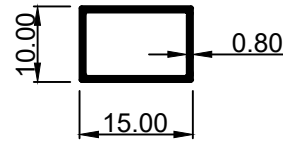

0.3699 Kg/12'

SECTION No.:-- SE-1174

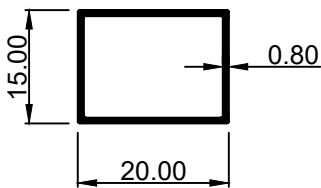

0.5280 Kg/12'

SECTION No.:-- SE-1175

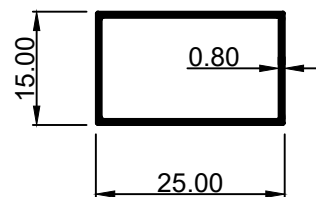

0.6071 Kg/12'

SHREENATHJI EXTRUSION

SECTION No.:- SE-1218

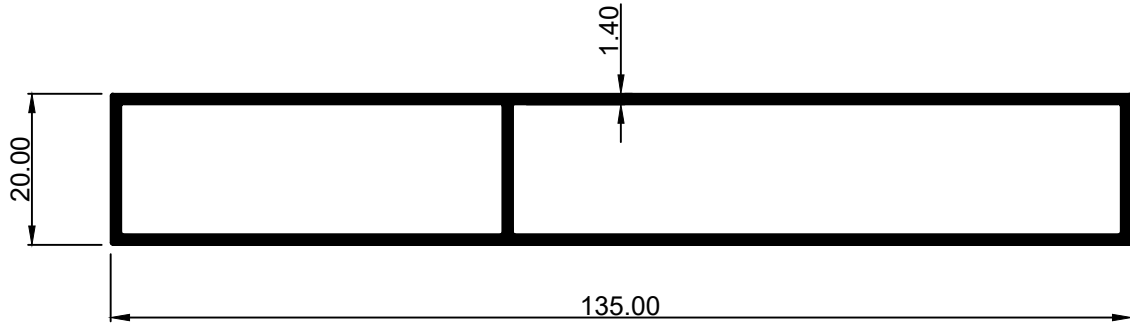

4.4500 Kg/12''

SECTION No.:- SE-1202

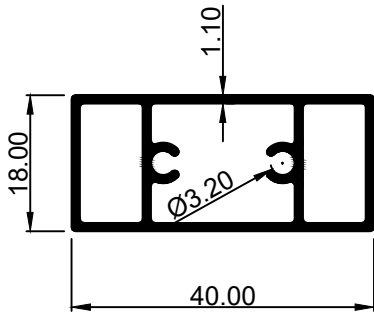

1.7396 Kg/12'

SECTION No.:- SE-1293

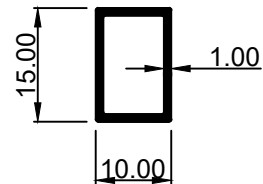

0.4545 Kg/12'

SECTION No.:- SE-1294

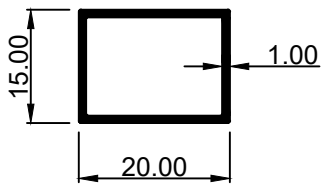

0.6522 Kg/12'

SECTION No.:- SE-1295

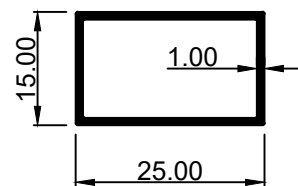

0.7510 Kg/12'

Rect Tube

Table 1

SEC NO	A	B	T	WT (KG/MTR)	WT (KG/12')	
SE 1173	15.00	10.00	0.80	0.104	0.370 - 0.420	
8748	18.00	25.00	1.20	0.245	0.900 - 1.000	
SE 1174	20.00	15.00	0.80	0.147	0.530 - 0.600	
SE 1175	25.00	15.00	0.80	0.169	0.610 - 0.700	
8449	25.00	15.00	1.90	0.382	1.350 - 1.550	
8698	30.00	15.00	0.90	0.191	0.700 - 0.850	
8402	35.00	20.00	0.90	0.273	0.950 - 1.100	
11401	36.00	24.00	0.69	0.204	0.750 - 0.850	
11402	36.00	24.00	0.79	0.232	0.850 - 1.000	
11403	36.00	24.00	0.88	0.273	1.000 - 1.200	
11404	36.00	24.00	1.09	0.327	1.200 - 1.400	
11405	36.00	24.00	1.25	0.382	1.400 - 1.600	
11406	36.00	24.00	1.52	0.464	1.700 - 1.900	
11407	46.50	23.50	0.70	0.232	0.850 - 1.000	
11408	46.50	23.50	0.81	0.273	1.000 - 1.150	
11409	48.00	24.00	0.90	0.327	1.200 - 1.350	
11410	48.00	24.00	1.00	0.368	1.350 - 1.500	
11411	48.00	24.00	1.12	0.409	1.500 - 1.700	
11412	48.00	24.00	1.25	0.464	1.700 - 1.900	
11413	48.00	24.00	1.42	0.519	1.900 - 2.100	
11414	48.00	24.00	1.60	0.600	2.200 - 2.400	
11415	48.00	24.00	2.00	0.750	2.750 - 3.000	
SE 692	50.00	12.00	1.50	0.464	1.700 - 1.900	
SE 685	50.00	19.00	1.50	0.508	1.800 - 2.000	
11416	50.80	25.40	2.00	0.790	2.890 - 3.000	
11417	61.50	37.50	0.84	0.440	1.600 - 1.750	
11418	62.00	24.00	0.75	0.327	1.200 - 1.350	
11419	62.00	24.00	0.85	0.368	1.350 - 1.450	
11420	62.00	24.00	1.00	0.437	1.600 - 1.700	
11421	62.00	24.00	1.12	0.491	1.800 - 2.000	
11422	62.00	24.00	1.40	0.600	2.200 - 2.400	
11423	63.00	38.00	0.73	0.382	1.400 - 1.550	
11424	63.00	38.00	0.82	0.646	1.700 - 1.900	
11425	63.00	38.00	0.95	0.519	1.900 - 2.100	
11426	63.00	38.00	1.10	0.573	2.100 - 2.400	
11427	63.00	38.00	1.40	0.737	2.700 - 2.900	
11428	63.00	38.00	1.70	0.887	3.250 - 3.450	
11429	63.00	38.00	1.95	0.792	3.800 - 4.200	
SE 530	68.00	14.00	1.20	0.546	1.950 - 2.100	
SE 681	75.00	12.00	1.50	0.670	2.350 - 2.550	
SE 682	75.00	19.00	1.50	0.724	2.550 - 2.750	
11430	75.00	25.00	0.65	0.409	1.500 - 1.700	
11431	75.00	25.00	8.00	3.633	13.300 - 13.400	
SE 693	75.00	38.00	1.20	0.890	3.200 - 3.400	
30195	80.00	25.00	1.00	0.570	2.00 - 2.200	
SE 413	81.00	20.00	1.30	0.683	2.500 - 2.700	
11432	81.25	38.10	0.85	0.519	1.900 - 2.100	
11433	81.25	38.10	0.95	0.573	2.100 - 2.300	

11434	81.25	38.10	1.40	0.792	3.100 - 3.400	
30596	89.00	32.00	1.80	1.150	4.150 - 4.400	
11435	95.00	24.00	0.81	0.491	1.800 - 2.000	
11436	95.00	24.00	1.0	0.601	2.200 - 2.400	
11437	95.00	24.00	1.15	0.710	2.600 - 2.800	
11438	46.20	23.20	0.65	0.238	0.870 - 1.000	
SE 683	100.00	12.00	1.50	0.922	3.750 - 3.950	
SE 684	100.00	19.00	2.25	0.923	3.400 - 3.600	
8412	100.00	50.00	1.30	1.038	3.800 - 4.00	
8908	100.00	63.00	1.50	1.312	4.800 - 5.100	
SE 779	110.00	40.00	2.00	1.612	5.800 - 6.100	
8185	116.00	38.00	1.40	1.148	4.150 - 4.350	
11438	121.90	23.94	1.09	0.850	3.000 - 3.300	
30578	125.00	50.00	1.40	1.340	4.700 - 4.900	
11439	125.00	35.00	2.00	1.684	6.000 - 6.300	
8325	130.00	63.00	3.00	3.046	11.100 - 11.500	
SE 807	150.00	50.00	2.00	2.158	7.800 - 8.200	

Round Tube

Table 1

NO	SECTION NO	A	B	T	WEIGHT/12'	
1	8741	15	11	2.00	1.300 TO 1.400	
2		16.70	7.50	4.60	1.600 TO 1.700	
3		19.00	13.00	3.00	1.450 TO 1.500	
4	8266	19.00	17.00	1.00	0.550 TO 0.600	
5	8095	22.00	12.00	5.00	2.650 TO 2.750	
6	SE 473	25.40	19.10	3.15	2.150 TO 2.250	
7		25.40	21.40	2.00	1.500 TO 1.600	
8	8083	25.40	22.80	1.30	1.050 TO 1.100	
9	8100	26.00	12.00	7.00	4.100 TO 4.150	
10	8187	27.00	12.00	7.50	4.450 TO 5.550	
11	SE 472	31.00	14.00	8.50	5.900 TO 6.100	
12	8188	32.00	20.00	6.00	5.000 TO 5.100	
13	11105	32.00	28.00	2.00	1.900 TO 2.000	
14	8116	32.00	25.00	3.50	3.150 TO 3.250	
15	8188	32.00	27.00	2.50	2.400 TO 2.500	
16	8340	33.00	30.00	1.50	1.550 TO 1.650	
17	8081	35.00	23.00	6.00	5.350 TO 5.450	
18	SE 283	36.20	32.20	2.00	2.150 TO 2.250	
19	SE 475	38.00	23.00	7.50	7.100 TO 7.250	
20	SE 476	38.00	26.00	6.00	5.900 TO 6.100	
21	SE 474	38.10	31.75	3.18	3.450 TO 3.550	
22	SE 477	40.00	30.00	5.00	5.450 TO 5.550	
23	SE 478	45.00	35.00	5.00	6.200 TO 6.300	
24	SE 334	48.00	40.00	4.00	5.150 TO 5.250	
25	SE 334	48.50	40.00	4.25	5.150 TO 5.250	
26	30068	48.80	47.00	0.90	1.300 TO 1.400	
27	SE 334	5.00	40.00	5.00	7.300 TO 7.400	
28	8292	50.00	25.00	12.50	14.500 TO 14.600	
29	SE 479	50.80	44.45	3.18	4.650 TO 4.750	
30	SE 480	54.00	34.00	10.00	13.750 TO 13.950	
31	16396	54.00	49.60	2.20	2.550 TO 3.650	
32	8341	55.50	52.00	1.75	3.000 TO 3.100	
33	8113	60.00	54.00	3.00	5.300 TO 5.450	
34	8080	60.50	40.00	10.25	16.100 TO 16.300	
35	SE 335	60.50	50.50	5.00	8.700 TO 8.850	
36	SE 481	63.50	57.10	3.20	6.000 TO 6.100	
37	SE 335	63.50	50.80	6.35	11.600 TO 11.750	
38	SE 482	70.00	60.00	5.00	10.200 TO 10.350	
39	8322	72.00	66.00	3.00	6.400 TO 6.600	
40	SE 418	74.00	51.00	11.50	22.050 TO 22.300	
41	8612	74.00	58.00	8.00	16.400 TO 16.600	
42	8663	75.70	51.70	12.00	23.350 TO 23.550	
43	SE 484	76.10	57.00	9.55	19.600 TO 19.800	
44	SE 336	76.20	63.50	6.35	14.200 TO 14.350	
45	SE 483	76.20	69.84	3.18	7.200 TO 7.300	
46	8418	76.50	51.00	12.75	25.550 TO 25.750	
47	8288	78.00	73.00	2.50	5.900 TO 6.100	
48	SE 485	80.00	60.00	10.00	21.700 TO 21.800	

49	SE 486	80.00	70.00	5.00	11.700 TO 11.800	
50	8159	80.00	75.00	2.50	6.100 TO 6.150	
51	SE 680	82.20	76.20	3.00	7.100 TO 7.200	
52	8641	85.00	80.00	2.50	6.950 TO 7.100	
53	SE 337	88.90	76.20	6.35	17.200 TO 17.350	
54	8408	90.00	66.00	12.00	28.150 TO 28.350	
55		101.00	95.00	3.00	8.400 TO 8.600	
56	SE 338	101.60	88.90	6.35	19.250 TO 19.450	
57	SE 488	105.00	78.00	13.50	38.500 TO 38.800	
58	8291	112.50	69.00	21.75	61.800 TO 62.100	
59	SEE 489	114.30	101.60	6.35	21.550 TO 21.750	
60	SE 339	127.00	114.20	6.40	24.350 TO 24.550	
61		150.00	140.10	4.95	22.400 TO 22.600	
62	30181	160.00	152.00	4.00	19.900 TO 20.100	

Flat Bar

Table 1

NO	WIDTH	THICKNESS	WEIGHT/12'				
1	12	3	0.300 TO 0.400				
2	12	5	0.550 TO 0.650				
3	15	2	0.250 TO 0.300				
4	15	6	0.850 TO 0.900				
5	17	4	0.650 TO 0.700				
6	19	2	0.350 TO 0.400				
7	20	1.5	0.300 TO 0.400				
8	20	3	0.650 TO 0.700				
9	20	6	1.200 TO 1.300				
10	20	10	1.950 TO 2.050				
11	23	8	1.850 TO 1.950				
12	25	1.6	0.370 TO 0.420				
13	25	2	0.500 TO 0.550				
14	25	3	0.750 TO 0.800				
15	25	5	1.200 TO 1.300				
16	25	6	1.500 TO 1.600				
17	25	8	1.900 TO 2.000				
18	25	10	2.480 TO 2.530				
19	25	12	2.950 TO 3.050				
20	25	15	3.600 TO 3.700				
21	25	28	6.000 TO 6.100				
22	28	4	1.050 TO 1.100				
23	30	2	0.550 TO 0.600				
24	30	3	0.950 TO 1.000				
25	30	6	1.750 TO 1.800				
26	30	8	2.400 TO 2.500				
27	30	10	2.950 TO 3.050				
28	30	12	3.600 TO 3.700				
29	32	12	3.750 TO 3.850				
30	38	1.6	1.550 TO 1.650				
31	38	2	1.950 TO 2.050				
32	40	3	1.150 TO 1.200				
33	40	4	1.700 TO 1.850				
34	40	6	2.350 TO 2.450				
35	40	10	4.050 TO 4.150				
36	40	12	4.800 TO 4.900				
37	43.5	2	0.850 TO 0.900				
38	50	3	1.500 TO 1.600				
40	50	5	2.400 TO 2.500				
41	50	6	2.950 TO 3.050				
42	50	8	4.000 TO 4.100				
43	50	10	5.100 TO 5.200				
44	50	12	6.050 TO 6.150				
45	50	25	12.300 TO 12.600				
46	55	2	1.050 TO 1.100				
47	55	5	2.700 TO 2.800				
48	56	4	2.000 TO 2.100				
49	60	6	3.500 TO 3.600				

50	60	10	6.050 TO 6.150				
51	60	12	7.200 TO 7.300				
52	63	6	3.700 TO 3.800				
53	63	10	6.200 TO 6.300				
54	63	12	7.450 TO 7.550				
55	63	32	19.800 TO 20.100				
56	75	6	4.500 TO 4.600				
57	75	10	7.550 TO 7.650				
58	75	12	9.200 TO 9.300				
59	80	6	4.500 TO 4.600				
60	80	10	8.200 TO 8.300				
61	80	12	8.700 TO 9.800				
62	80	15	11.800 TO 12.000				
63	92	1.4	1.150 TO 1.200				
64	100	6	6.050 TO 6.150				
65	100	10	10.200 TO 10.400				
66	100	12	12.050 TO 12.250				
67	100	15	14.700 TO 14.800				
68	102	32	32.200 TO 32.500				
69	120	10	11.900 TO 12.100				
70	125	6	7.450 TO 7.550				
71	125	10	12.500 TO 12.700				
72	125	12	15.000 TO 15.200				
73	128	2.5	3.150 TO 3.250				
74	130	3	3.850 TO 3.950				
75	150	6	9.050 TO 9.150				
76	150	10	15.000 TO 15.200				
77	150	12	18.100 TO 18.300				
78	152	16	24.100 TO 24.400				
79	160	10	15.900 16.100				
80	160	12	19.100 TO 19.300				
81	175	12	20.400 TO 20.600				
82	200	4	7.900 TO 8.200				
83	200	6	11.750 TO 11.950				
84	200	10	20.000 TO 20.200				
88	200	12	24.000 TO 24.300				

Round Bar

Table 1

SEC NO	A	WT. (KG/MTR.)	WT. (KG/12')			
11000	20.00	0.848	3.060 - 3.300			
11001	36.00	2.745	9.800 - 10.500			
11002	38.00	3.060	11.000 - 11.800			
11003	40.00	3.390	12.200 - 13.000			
11004	50.00	5.290	19.250 - 20.250			
11005	11.30	0.270	0.990 - 1.100			
11006	35.00	2.590	9.500 - 9.800			
11007	30.00	1.907	6.950 - 7.250			
11008	27.00	1.545	5.650 - 5.950			
11009	24.30	1.594	5.800 - 6.100			
11010	19.00	0.765	2.750 - 3.050			
11011	17.00	0.612	2.200 - 2.500			
11012	17.30	0.634	2.300 - 2.600			
11013	16.00	0.542	1.950 - 2.250			
11014	8.000	0.135	0.450 - 0.650			
11015	7.000	0.103	0.350 - 0.550			
11016	32.00	2.170	7.900 - 8.200			