

# SHREENATHJI EXTRUSION

SEC. NO:-30580

SE-215

SEC. NO:-30581

SE-217

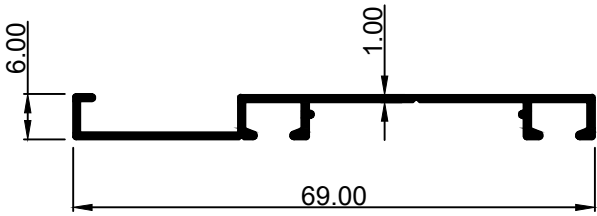

WEIGHT:- 1.000 kg/12'

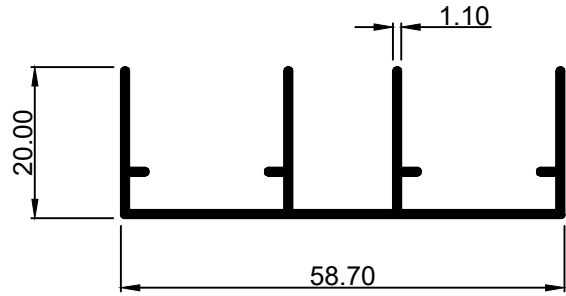

WEIGHT:- 1.561 kg/12'

SEC. NO:-30582

SE-207

SEC. NO:-30583

SE-216

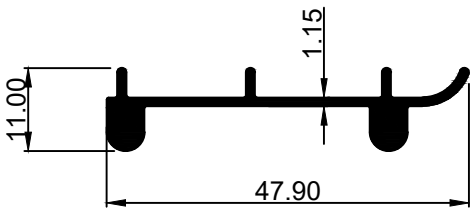

WEIGHT:- 1.233 kg/12'

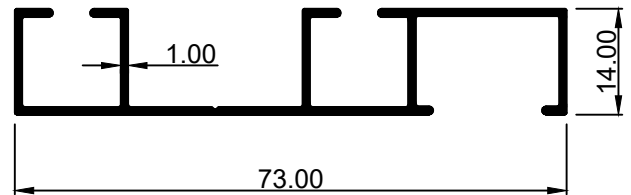

WEIGHT:- 1.585 kg/12'

SEC. NO:-30584

SE-205

SEC. NO:-15966

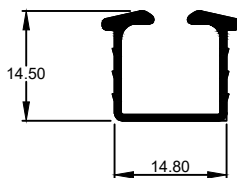

WEIGHT:- 0.519 kg/12'

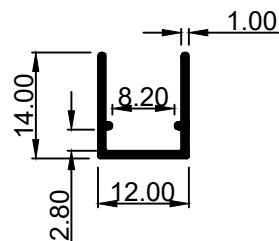

WEIGHT:- 0.390 kg/12'

# SHREENATHJI EXTRUSION

SEC. NO:-16113

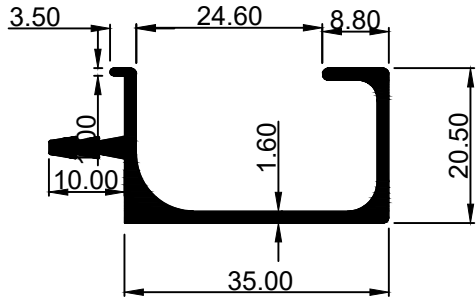

WEIGHT:- 1.700 kg/12'

SEC. NO:-16114

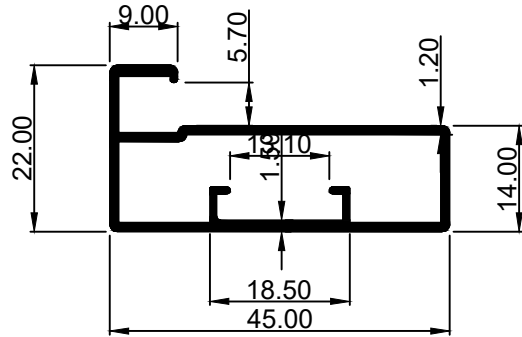

WEIGHT:- 1.740 kg/12'

SEC. NO:-16115

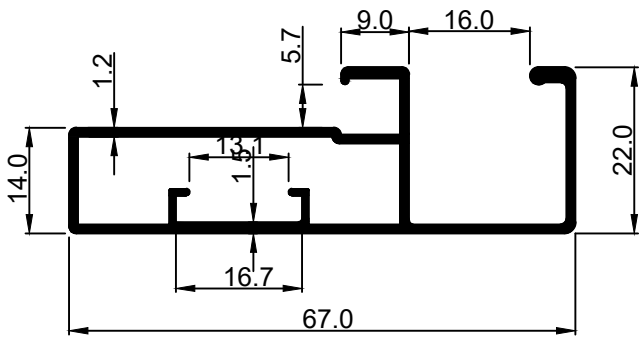

WEIGHT:- 2.350 kg/12'

SEC. NO:-16116

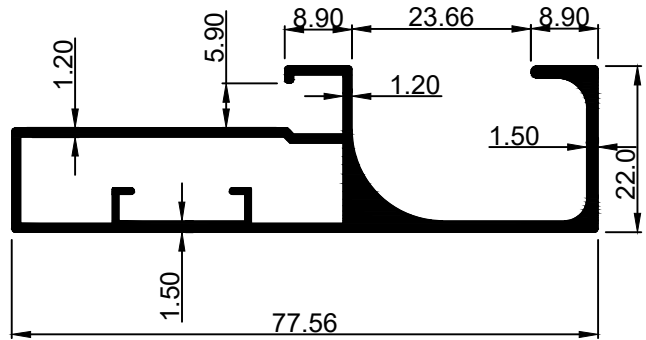

WEIGHT:- 3.000 kg/12'

SEC. NO:-30036                      16115

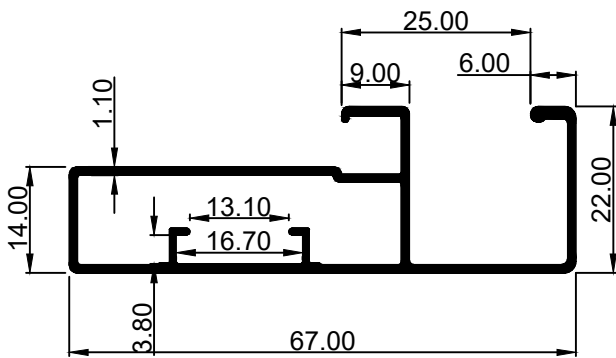

WEIGHT:- 2.111 kg/12'

SEC. NO:-30037                      16210

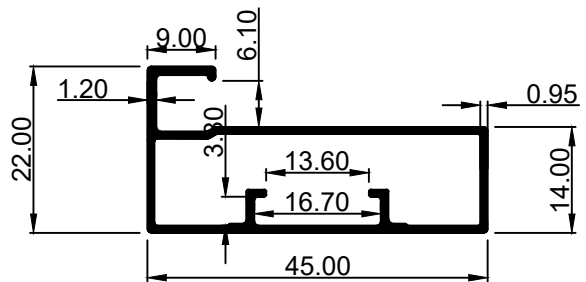

WEIGHT:- 1.396 kg/12'

SHREENATHJI EXTRUSION

SEC. NO:-16383

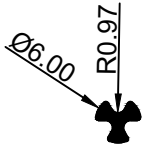

WEIGHT:- 0.158 kg/12'

SEC. NO:-16384

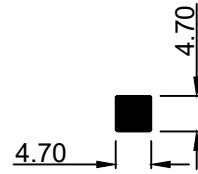

WEIGHT:- 0.217 kg/12'

SEC. NO:-30038

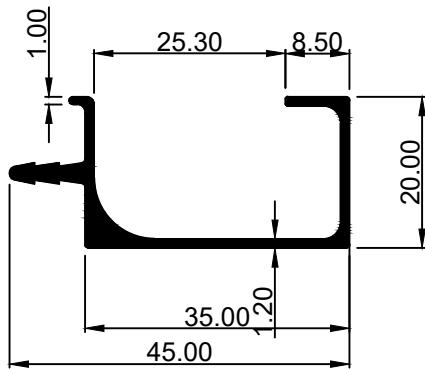

WEIGHT:- 1.344 kg/12'

SEC. NO:-30278

SE-45

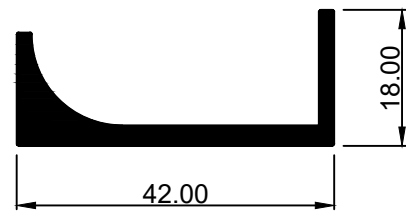

WEIGHT:- 1.970 kg/12'

SEC. NO:-30279

SE-46

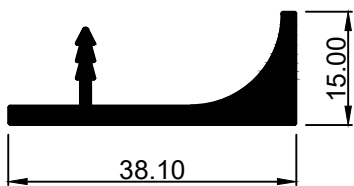

WEIGHT:- 1.711 kg/12'

SEC. NO:-30298

SE-68

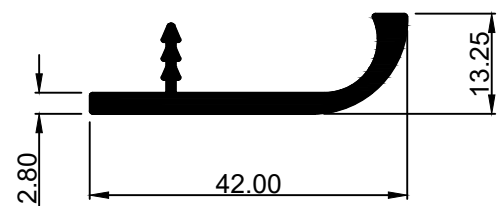

WEIGHT:- 1.501 kg/12'

# SHREENATHJI EXTRUSION

SEC. NO:-30313

SE-82

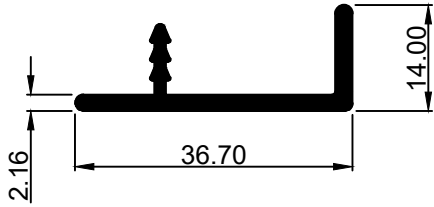

WEIGHT:- 1.212 kg/12'

SEC. NO:-30314

SE-83

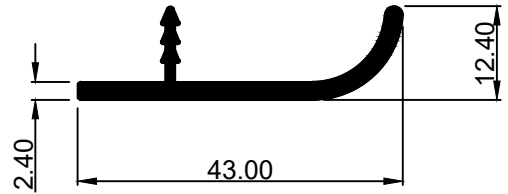

WEIGHT:- 1.302 kg/12'

SEC. NO:-30327

SE-128

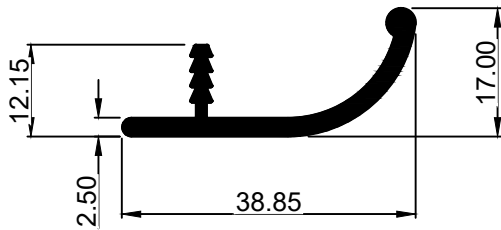

WEIGHT:- 1.382 kg/12'

SEC. NO:-30516

8234

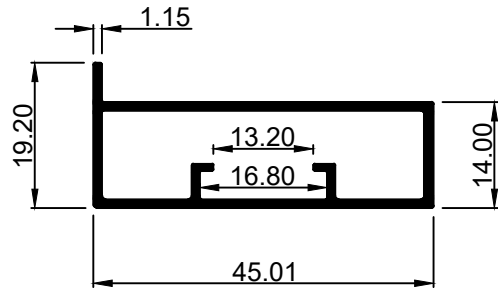

WEIGHT:- 1.500 kg/12'

SEC. NO:-30517

8233

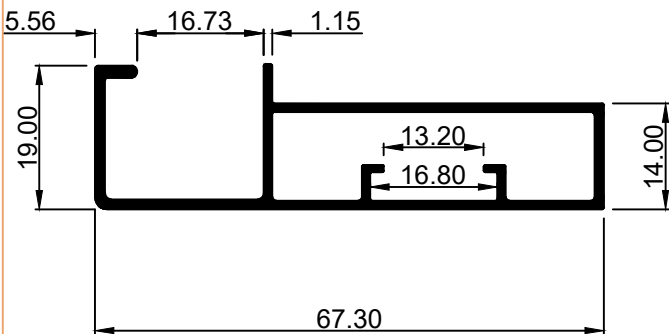

WEIGHT:- 2.080 kg/12'

SEC. NO:-30590

SE-204

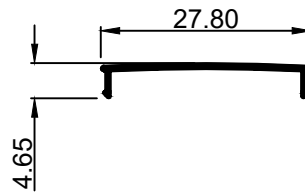

WEIGHT:- 0.270 kg/12'

SHREENATHJI EXTRUSION

SEC. NO:-15925

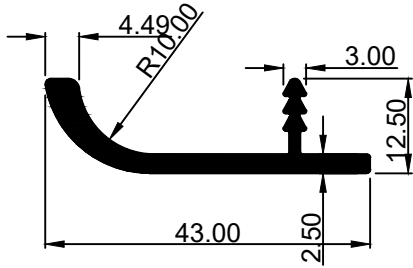

WEIGHT:- 1.500 kg/12'

SEC. NO:-30276

SE-43

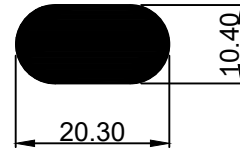

WEIGHT:- 1.857 kg/12'

SEC. NO:-30280

SE-47

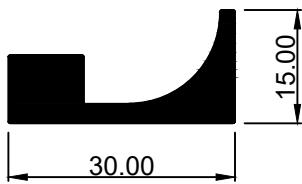

WEIGHT:- 1.953 kg/12'

SEC. NO:-30281

SE-52

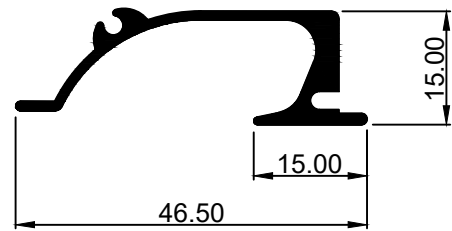

WEIGHT:- 1.316 kg/12'

SEC. NO:-30282

SE-53

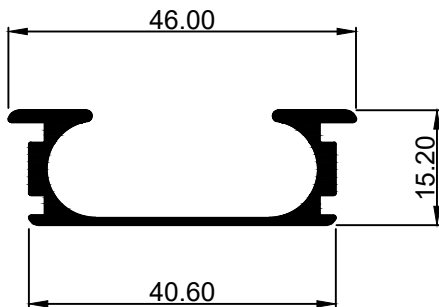

WEIGHT:- 1.400 kg/12'

SEC. NO:-30283

SE-51

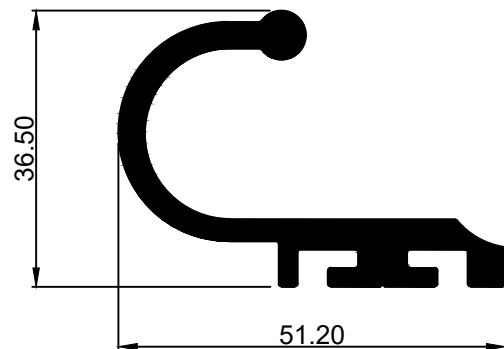

WEIGHT:- 3.909 kg/12'

SHREENATHJI EXTRUSION

SEC. NO:-30176

AH-329

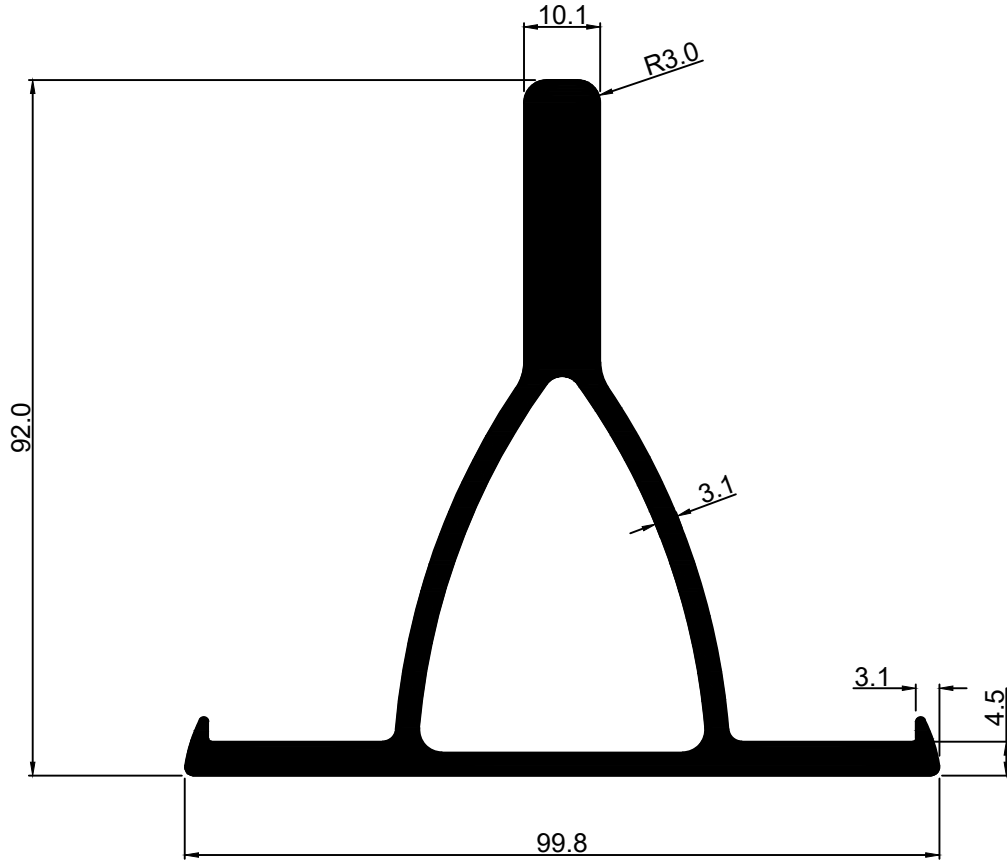

WEIGHT:- 11.050 kg/12'

SEC. NO:-30284

SE-50

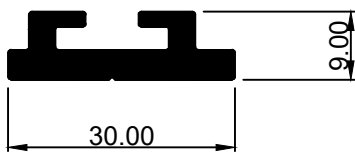

WEIGHT:- 1.675 kg/12'

SEC. NO:-30293

SE-61

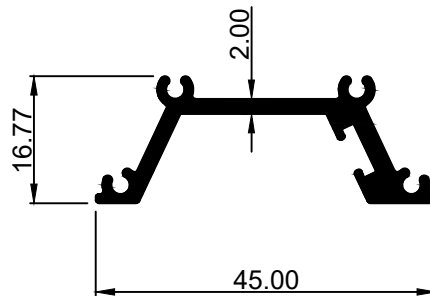

WEIGHT:- 1.610 kg/12'

# SHREENATHJI EXTRUSION

SEC. NO:-30315

SE-100

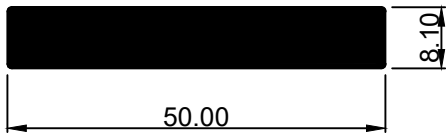

WEIGHT:- 4.000 kg/12'

SEC. NO:-30294

SE-62

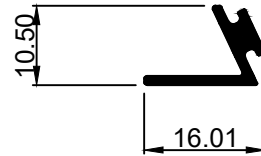

WEIGHT:- 0.431 kg/12'

SEC. NO:-30295

SE-65

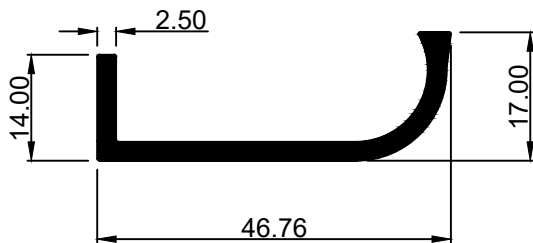

WEIGHT:- 1.705 kg/12'

SEC. NO:-30296

SE-66

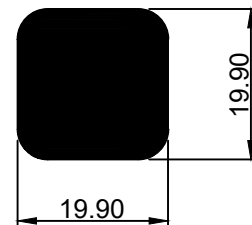

WEIGHT:- 3.777 kg/12'

SEC. NO:-30297

SE-67

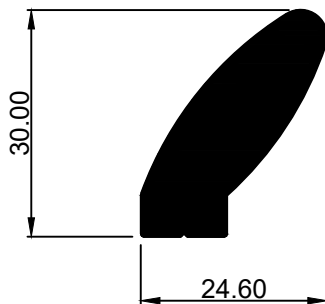

WEIGHT:- 3.624 kg/12'

SEC. NO:-30490

8250

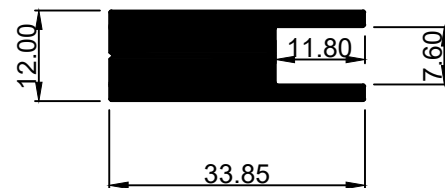

WEIGHT:- 3.125 kg/12'

SHREENATHJI EXTRUSION

SEC. NO:-30299

SE-69

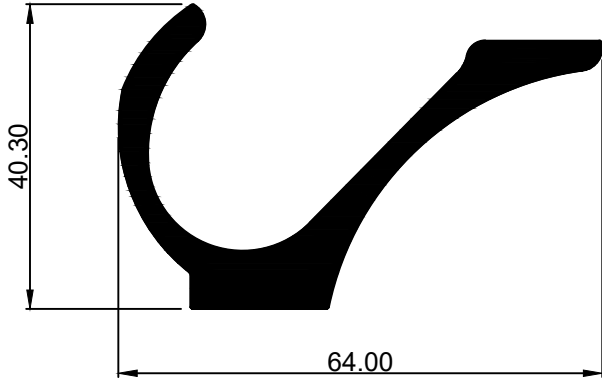

WEIGHT:- 5.240 kg/12'

SEC. NO:-30300

SE-73

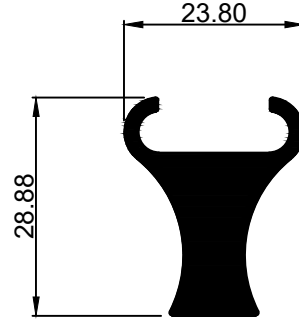

WEIGHT:- 2.756 kg/12'

SEC. NO:-30301

SE-71

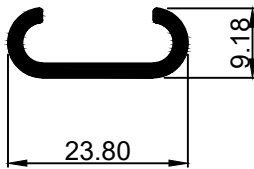

WEIGHT:- 0.701 kg/12'

SEC. NO:-30302

SE-72

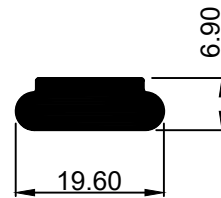

WEIGHT:- 1.183 kg/12'

SEC. NO:-30303

SE-74

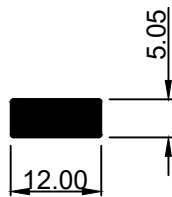

WEIGHT:- 0.597 kg/12'

SEC. NO:-30304

SE-75

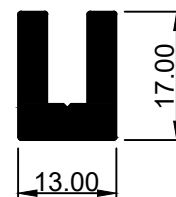

WEIGHT:- 1.540 kg/12'

SHREENATHJI EXTRUSION

SEC. NO:-30305

SE-76

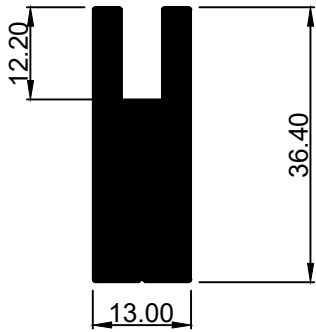

WEIGHT:- 4.033 kg/12'

SEC. NO:-30306

SE-77

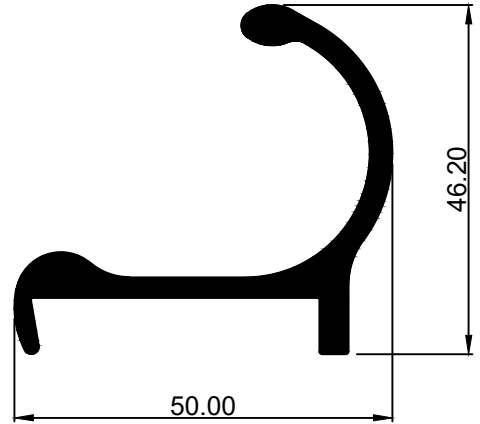

WEIGHT:- 3.532 kg/12'

SEC. NO:-30307

SE-78

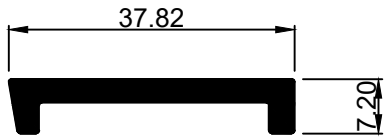

WEIGHT:- 1.423 kg/12'

SEC. NO:-30308

SE-79

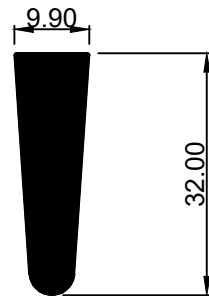

WEIGHT:- 2.425 kg/12'

SEC. NO:-30309

SE-81

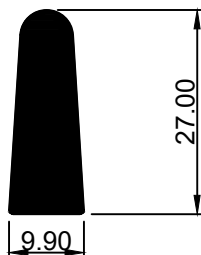

WEIGHT:-2.160 kg/12'

SEC. NO:-30310

SE-80

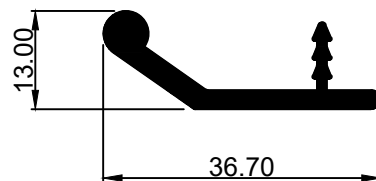

WEIGHT:- 1.329 kg/12'

SEC. NO:-30321

SE-102

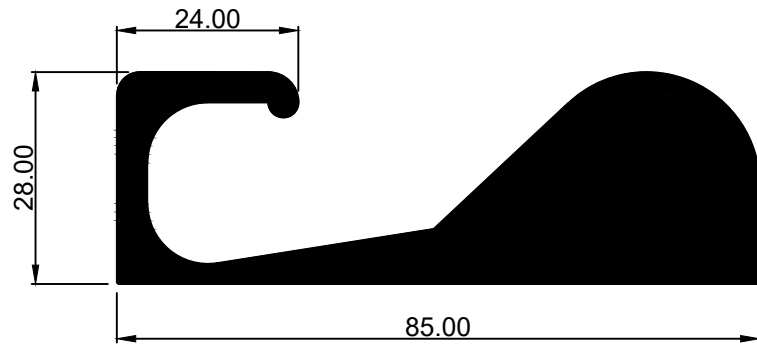

WEIGHT:- 12.962 kg/12'

SEC. NO:-30323

SE-141

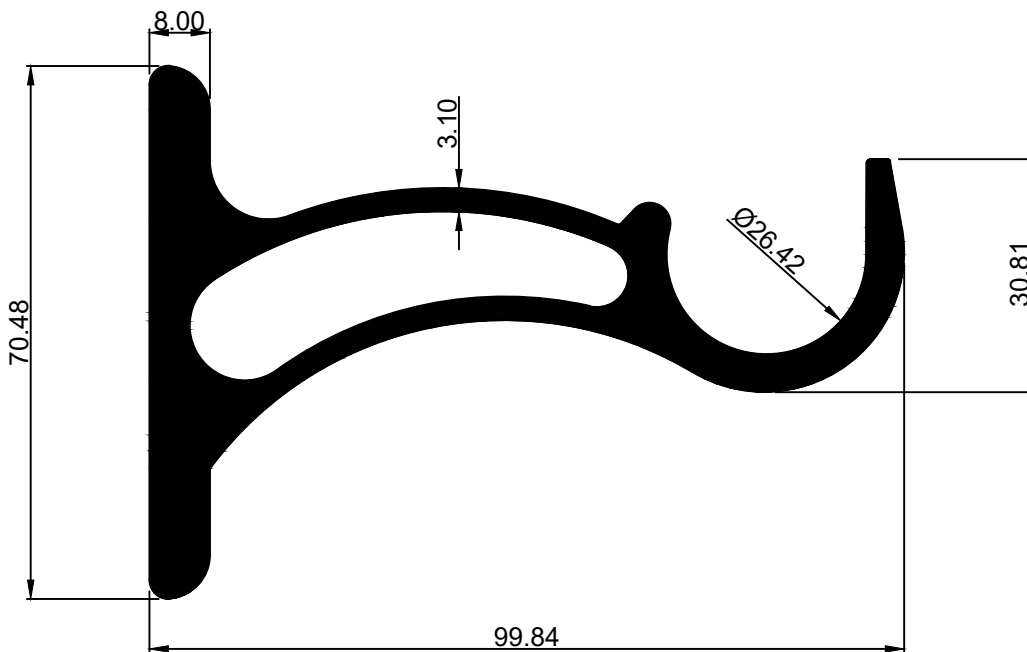

WEIGHT:- 13.013 kg/12'

SEC. NO:-30342

8033

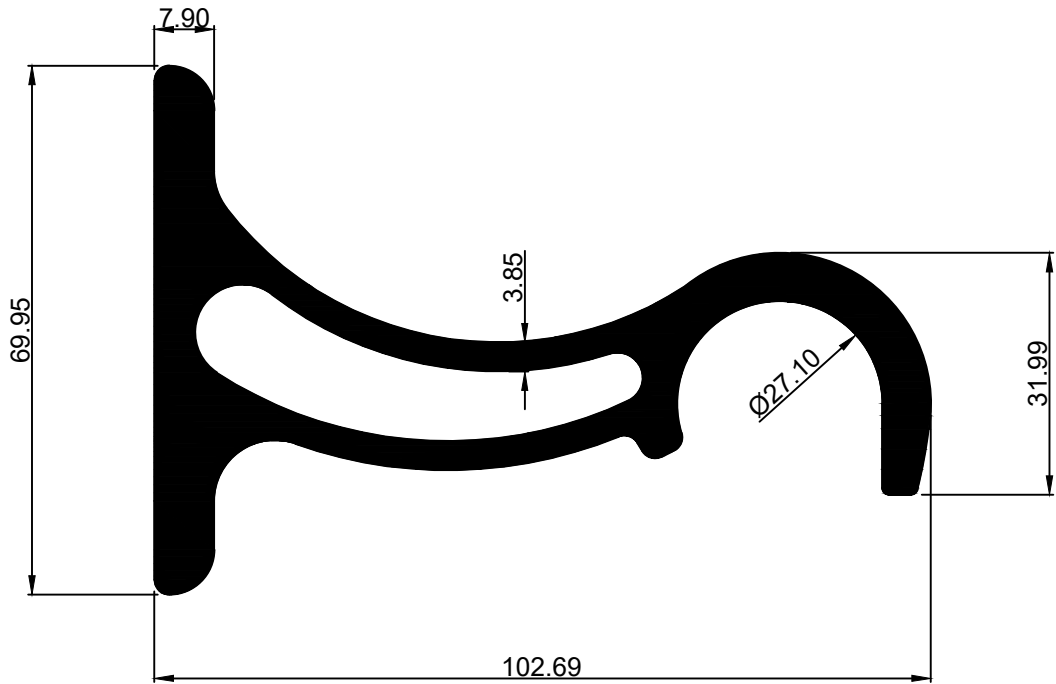

WEIGHT:- 14.700 kg/12'

SEC. NO:-30343

8034

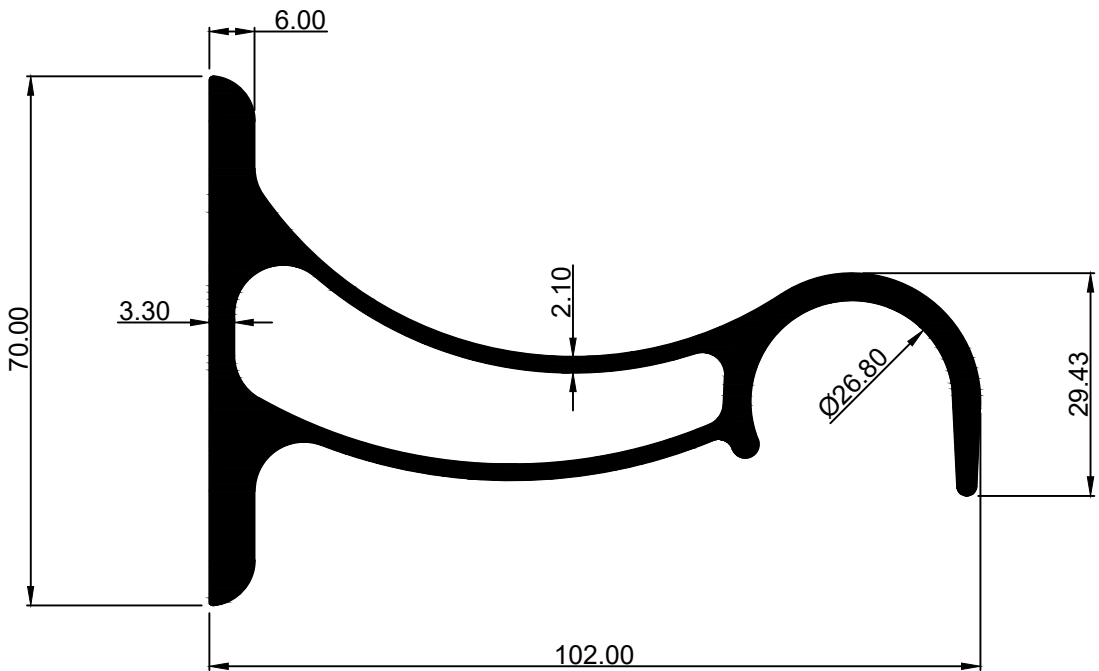

WEIGHT:- 9.400 kg/12'

SHREENATHJI EXTRUSION

SEC. NO:-30491

8251

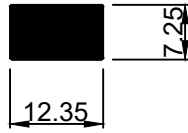

WEIGHT:- 0.885 kg/12'

SECTION No.:- SE-709

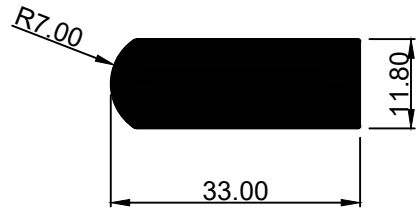

3.736 Kg/12'

SECTION No.:- SE-710

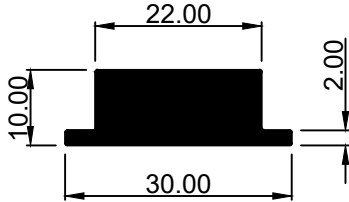

2.331 Kg/12'

SECTION No.:- SE-711



2.908 Kg/12'

SECTION No.:- SE-712

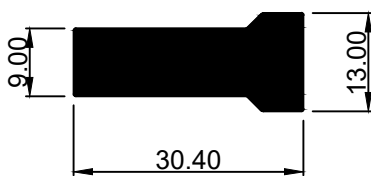

2.960 Kg/12'

SECTION No.:- SE-713

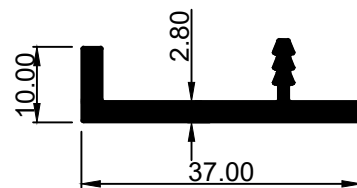

1.393 Kg/12'

# SHREENATHJI EXTRUSION

SECTION No.:- SE-714

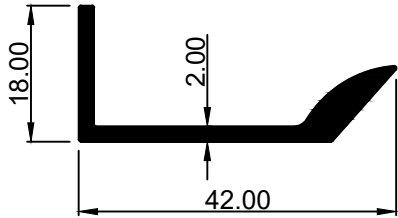

1.429 Kg/12'

SECTION No.:- SE-715

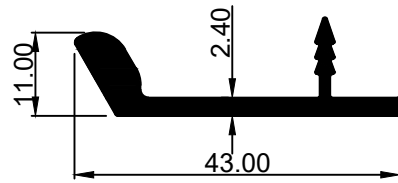

1.568 Kg/12'

SECTION No.:- SE-716

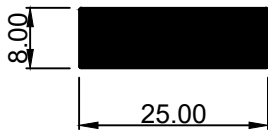

1.976 Kg/12'

SECTION No.:- SE-717

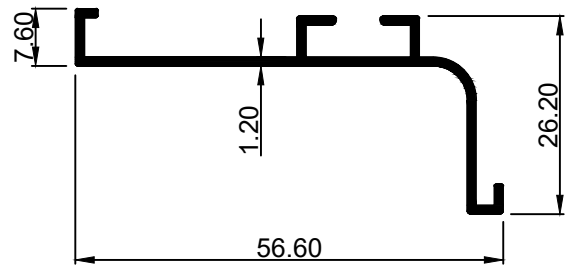

1.225 Kg/12'

SECTION No.:- SE-718

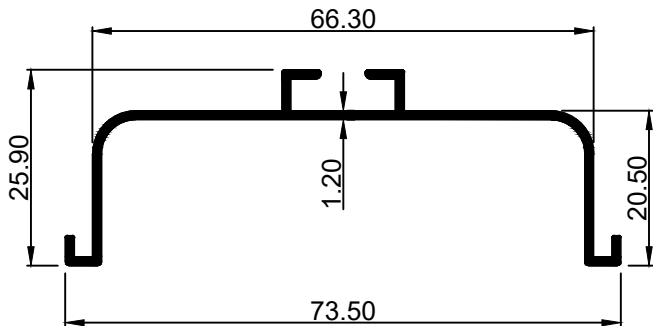

1.560 Kg/12'

SECTION No.:- SE-722

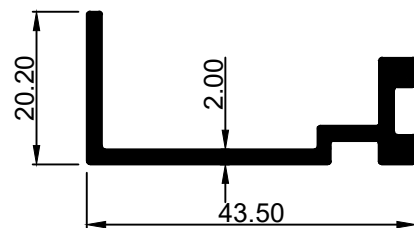

1.675 KG/12'

SHREENATHJI EXTRUSION

SECTION No.:- SE-723

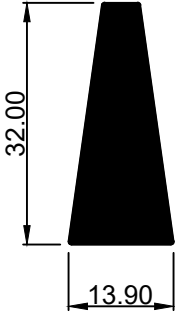

3.006 KG/12'

SECTION No.:- SE-724

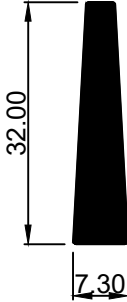

1.770 KG/12'

SECTION No.:- SE-730

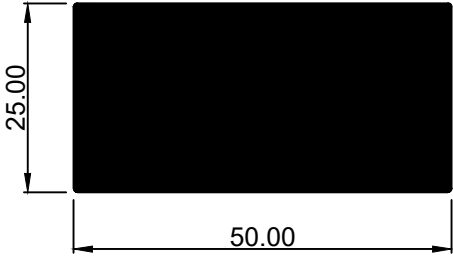

3.3744 KG/Mtr.

SECTION No.:- SE-731

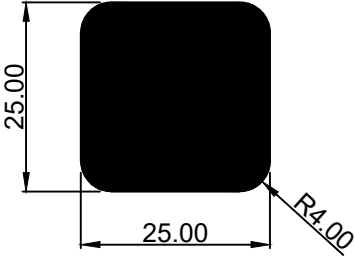

1.6504 KG/Mtr.

SECTION No.:-SE-761

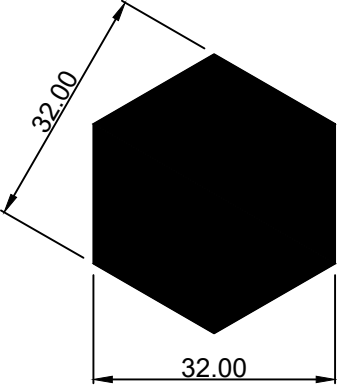

8.7634 Kg/12'

SECTION No.:-SE-762

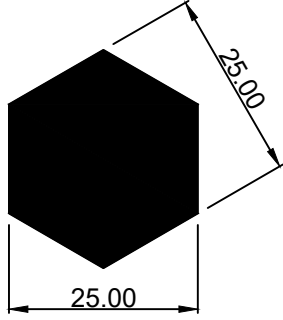

5.3487 Kg/12'

# SHREENATHJI EXTRUSION

SECTION No.: - SE-828

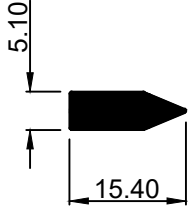

0.6455 Kg/12'

SECTION No.: - SE-884

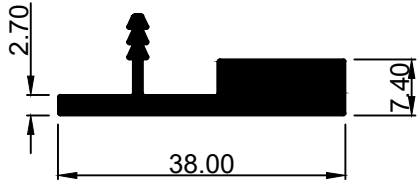

1.9863 KG/12'

SECTION No.: - SE-886

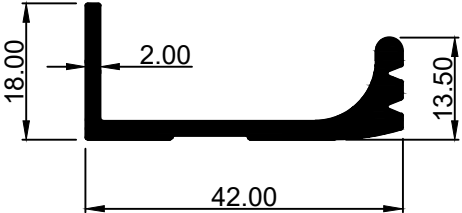

1.7192 KG/12'

SECTION No.: - SE-887

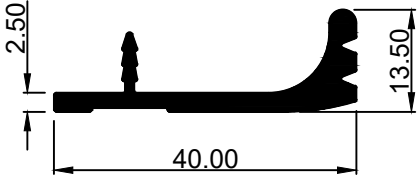

1.4836 KG/12'

SECTION No.: - SE-898

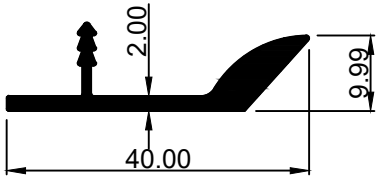

1.2882 KG/12'

SECTION No.: - SE-930

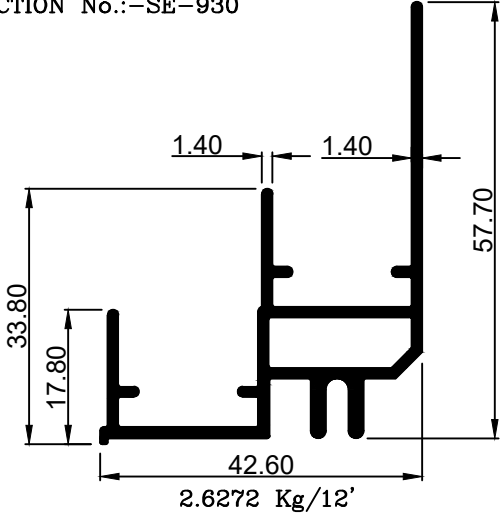

2.6272 Kg/12'

# SHREENATHJI EXTRUSION

SECTION No.:--SE-931

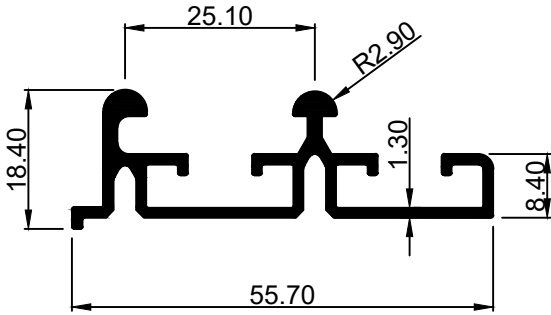

2.0988 Kg/12'

SECTION No.:--SE-939

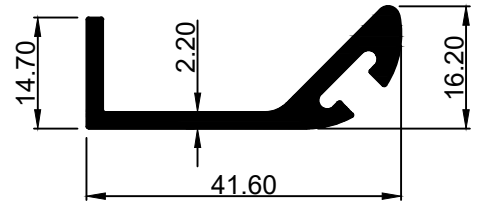

1.7464 KG/12'

SECTION No.:--SE-940

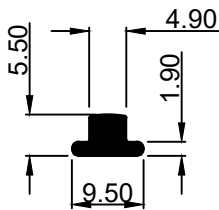

0.3412 KG/12'

SECTION No.:--SE-979

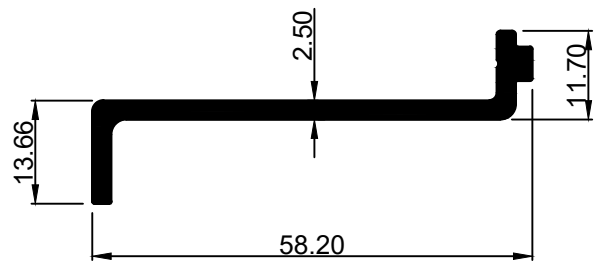

1.9790 Kg/12'

SECTION No.:--SE-993

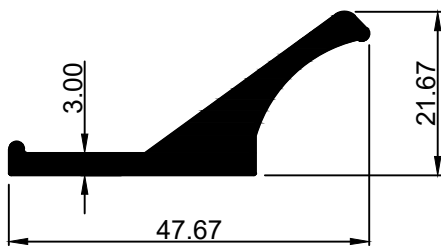

2.3851 Kg/12'

SECTION No.:-- SE-885

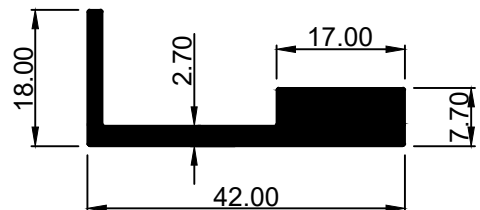

2.2622 KG/12'

# SHREENATHJI EXTRUSION

SECTION No.:—SE-894

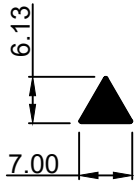

0.2309 KG/12'

SECTION No.:—SE-895

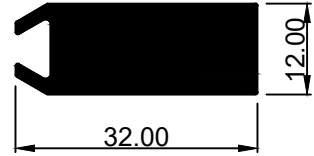

3.4209 KG/12'

SECTION No.:—SE-953

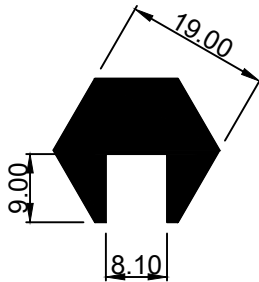

2.3690 Kg/12'

# Shreenathji

# Extrusion

30342

30343

SEC. NO:-30342

8033

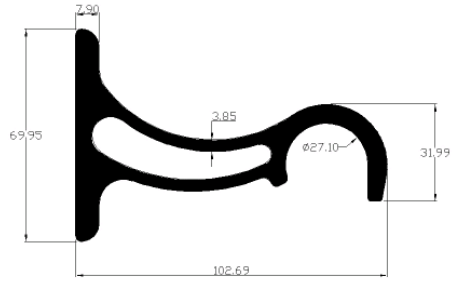

WEIGHT:- 14.700 kg/12'

FURNITURE

SEC. NO:-30343

8034

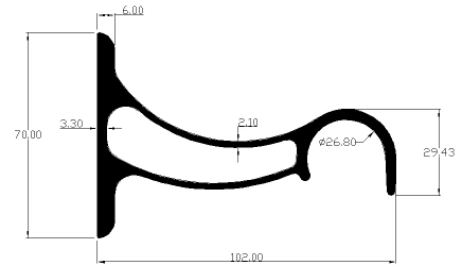

WEIGHT:- 9.400 kg/12'

FURNITURE

30490

30491

SEC. NO:-30490

8250



WEIGHT:- 3.125 kg/12'

FURNITURE

SEC. NO:-30491

8251

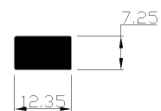

WEIGHT:- 0.885 kg/12'

FURNITURE

# Shreenathji

30506

SEC. NO:-30506

8237

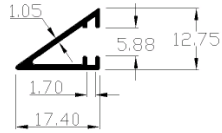

WEIGHT:- 0.440 kg/12'

FURNITURE

# Extrusion

30508

SEC. NO:-30508

8235

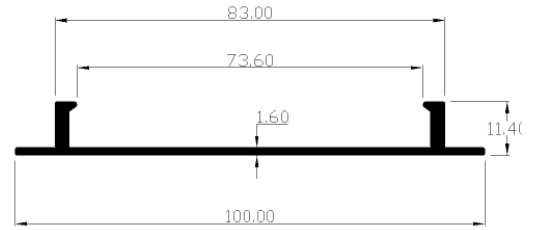

WEIGHT:- 1.340 kg/12'

FURNITURE

8289

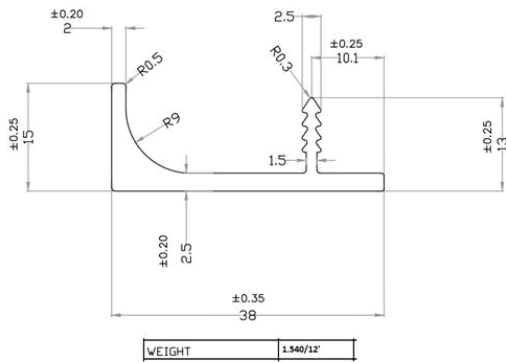

FURNITURE

8290

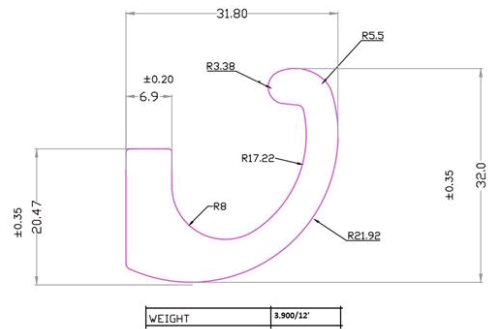

FURNITURE

8362

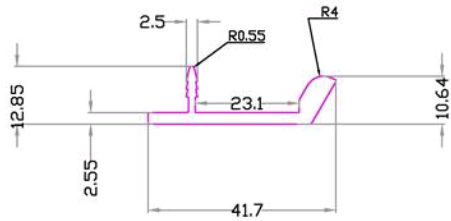

1.540kg/12'  
DIE NO.-8362

FURNITURE

8388

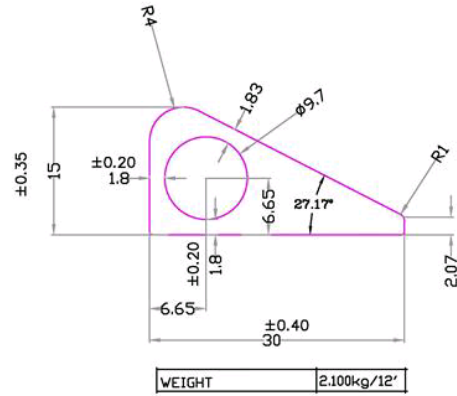

WEIGHT 2.100kg/12'

FURNITURE